



---

## AT A GLANCE :

---



The bond amount \$42,000,000 and is expected to be completed for the Fall 2026/2027 School Year.



Bond proceeds will go to building a High School. OISD does not currently have a dedicated High School Facility.



Enrollment at the District has increased each year by roughly 3% over a decade. This growth rate is expected to continue.



Construction of this facility addresses the issues that are challenging each campus in the District, allowing for future growth.



## VOTING INFORMATION

- Last day to register to vote:  
**Thursday, April 4th**
- Early Voting Begins:  
**Monday, April 22nd**
- Last Day for Early Voting:  
**Tuesday, April 30th**
  - Election Day:  
**Saturday, May 4th 7 a.m.–7 p.m.**
- Location to vote: Onalaska City Hall

*All District Community Residents can vote, in and out of city limits.*

---

## CONTACT US

(936) 646-1099

Anthony Roberts, Superintendent  
aroberts@onalaskaisd.net

[www.onalaskaisd.net](http://www.onalaskaisd.net)



# WE ARE GROWING!

## Student Enrollment and Staffing History

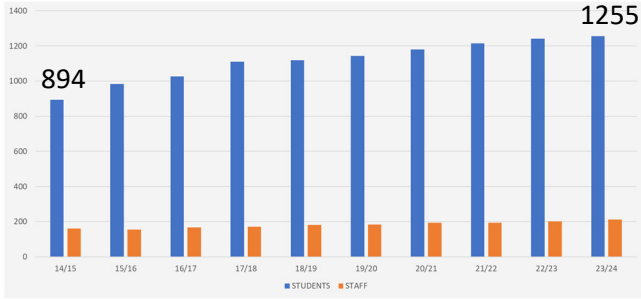

### CURRENT CAMPUS CHALLENGES DUE TO SPACE:

#### ONALASKA ELEMENTARY

- 720 Students (PreK-6th Grade)
- All classrooms occupied
- Congested traffic for car rider drop-off/pickup
- Limited extracurricular for 5th and 6th grade
- Eight grade levels creating a large age span (3 years-13 years)
- Lunches from 10:30a.m.-1:20p.m. due to number of grades

#### ONALASKA JUNIOR SENIOR HIGH

- 540 Students (7th-12th Grade)
- One classroom left for future staffing needs
- Career Technology Education classrooms are not designed for that purpose
- Conflicts created by shared facilities
- Large span between ages (12 years—19 years)
- Small parking and gymnasium eliminates the ability to host graduation and various other High School level events.

### 10 Year Projected Student Enrollment

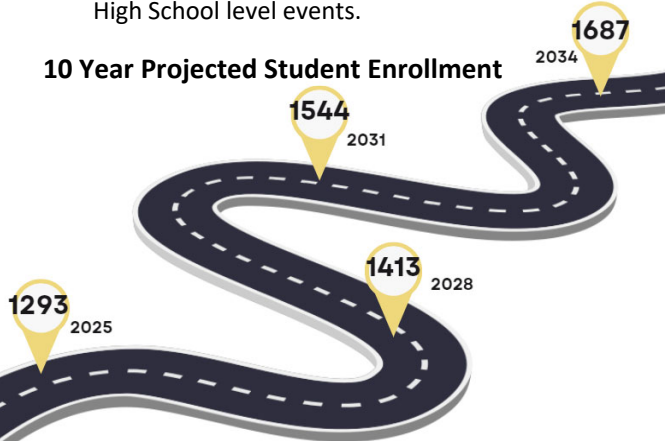

Based on 3% Growth Pattern

# WHY :

## Building Onalaska High School:

- Creates availability for future growth at all 3 campuses
- Allows district to realign grade levels
- Provides purpose designed facilities for CTE programs
- Allows extra-curricular programs for 5th & 6th graders
- Reduces traffic congestion at Onalaska Elementary
- Improves scheduling and lunch times at Onalaska Elementary
- Physical education and athletic facilities on each campus
- Provides opportunity for local graduation, hosting competitions, and provides facilities for community use and events

*Homeowners age 65 and older, who have filed Homestead Exemption will NOT see an increase in taxes associated with this Bond.*

# WHAT WILL IT COST?

## Monthly Tax Increase By Home Value From 23/24 to 24/25

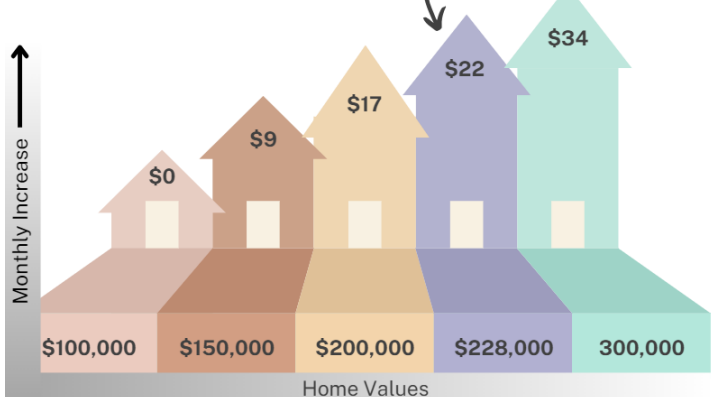

# WHERE :

Onalaska ISD already owns the property for the proposed project. The new High School facilities will cost \$42,000,000 and will be located adjacent to the currently existing Junior/Senior Campus.

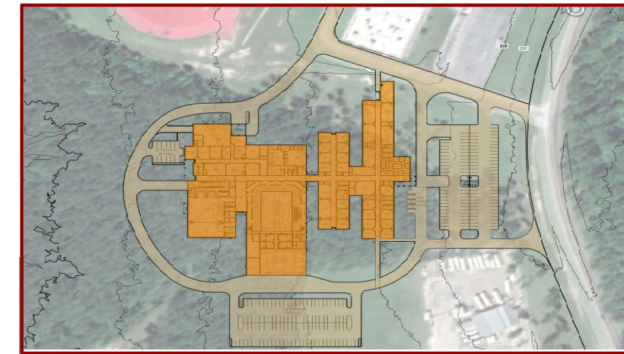

Did

YOU KNOW?



Onalaska ISD Total Tax Rate has been reduced by 0.4435 since 2015. The 2024 tax rate is 0.8545. The expected tax after the bond will be 1.0585

## Visit Our Website

<http://www.onalaskaisd.net>

to calculate the actual cost to you using our Tax Estimate Calculator